

Integrating MuleSoft with Authomize

Integration with MuleSoft provides visibility about the identities and assets on your organization’s MuleSoft account. After integration, Authomize provides visibility into MuleSoft, enabling improved identity security and automated access reviews.

MuleSoft integration workflow

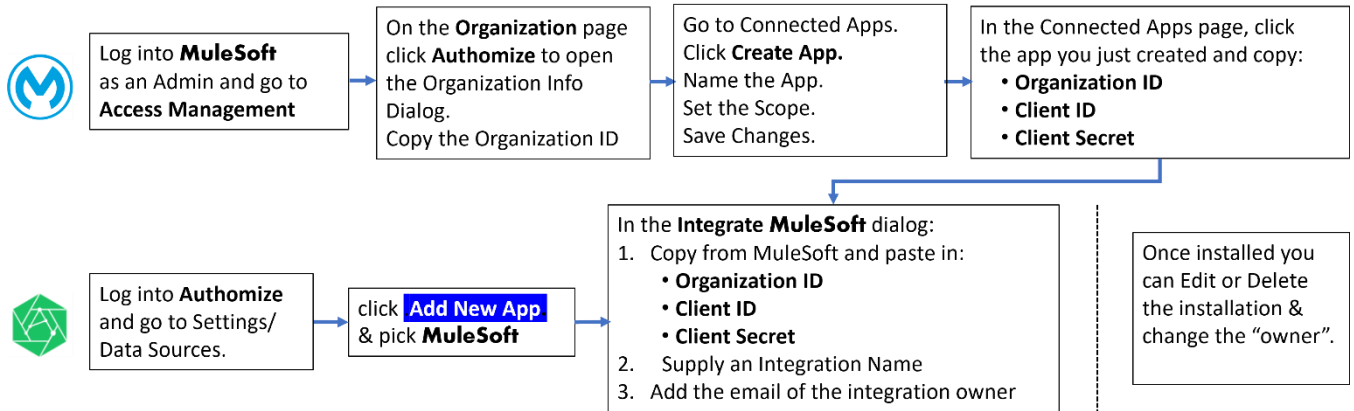

Set up Authomize in MuleSoft

1. Log into MuleSoft.
2. Go to **Access Management** or enter <https://anypoint.mulesoft.com/accounts/>.

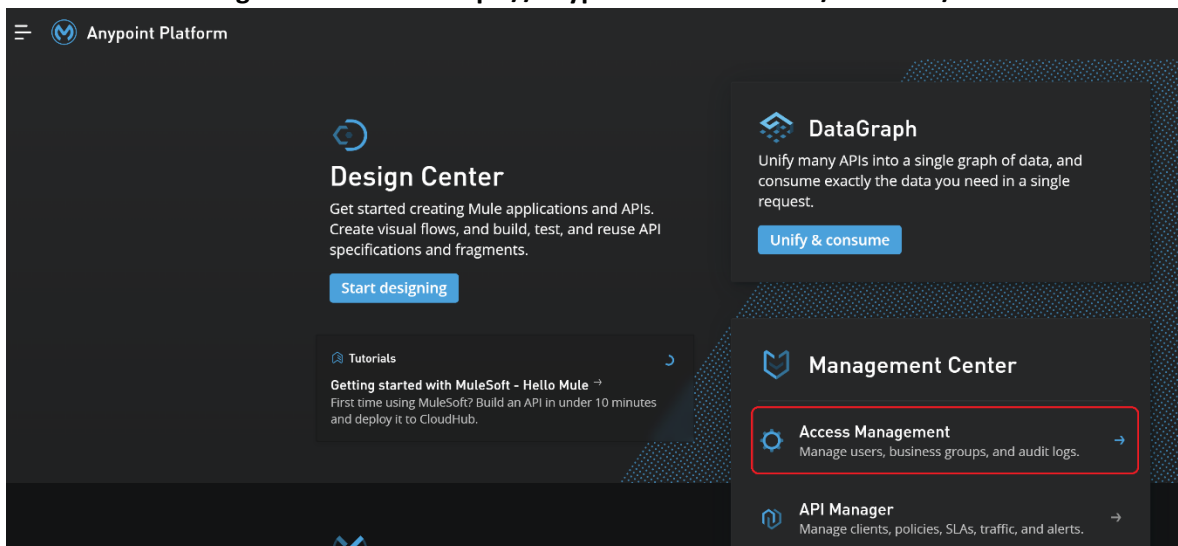

3. On the **Organization** page click **Authomize** to open the Organization Info Dialog.

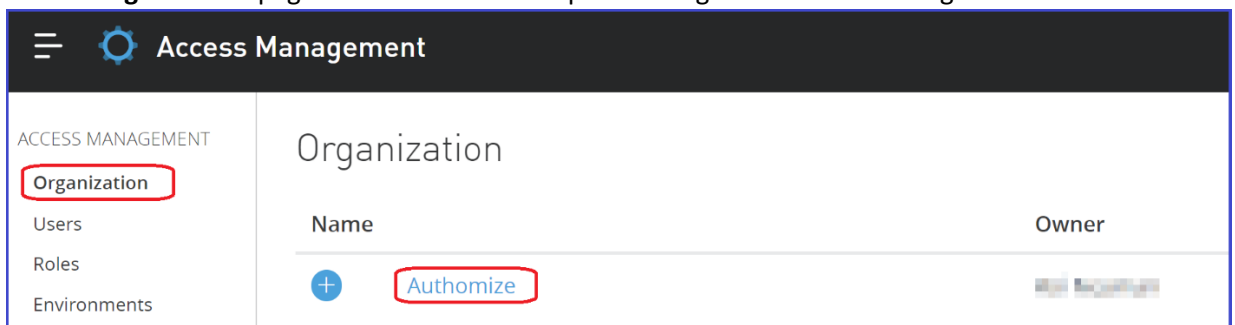

4. In the Organization Info Dialog, copy the Organization ID.

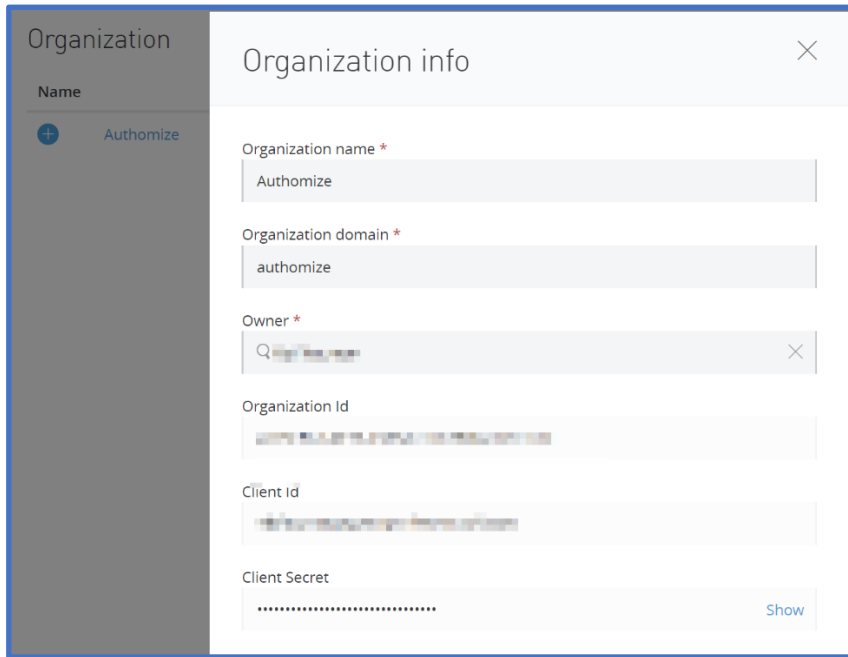

5. Click Connected Apps in the main menu. In the **Connected Apps** dialog click **Create app**.

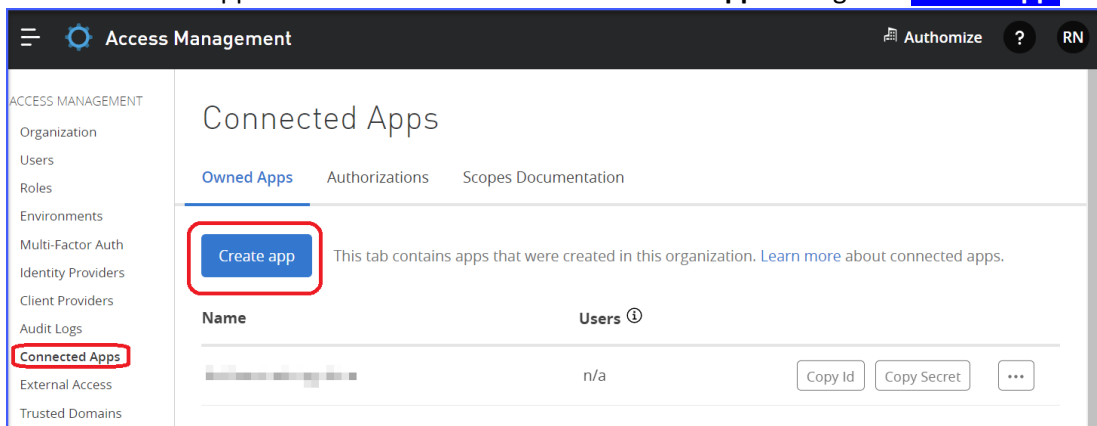

6. In the **Create App** dialog, give your app a name, select App acts on its own behalf. Then click **Add Scope**.

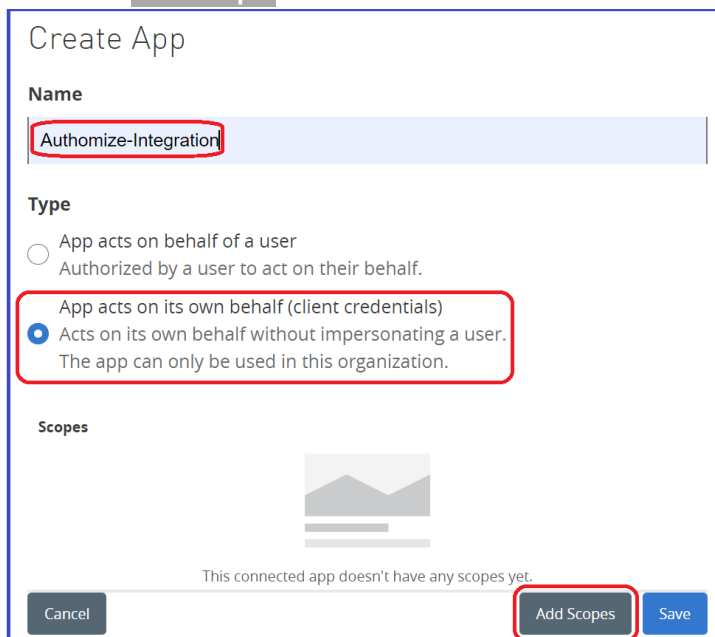

7. In the **Select Scopes** dialog, select **View Organization** and **View Users in a particular organization**. Then click **Next**.

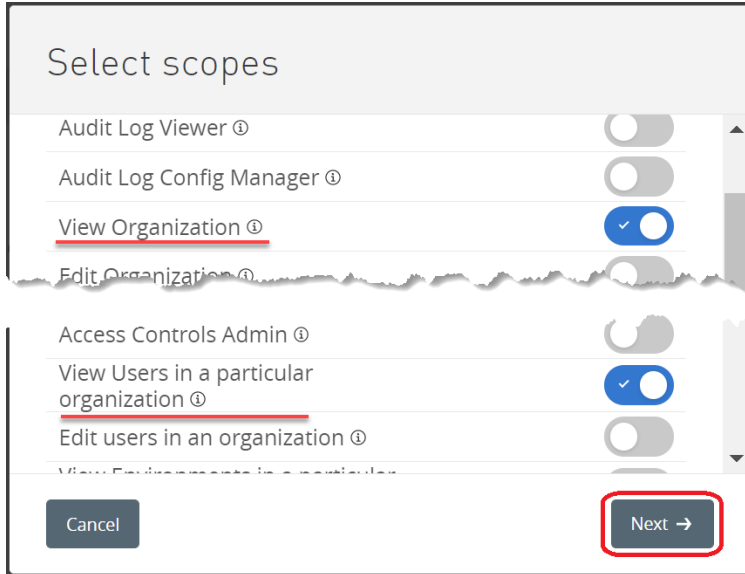

8. In the **Select Context** dialog select **Authomize** and click **Review**.

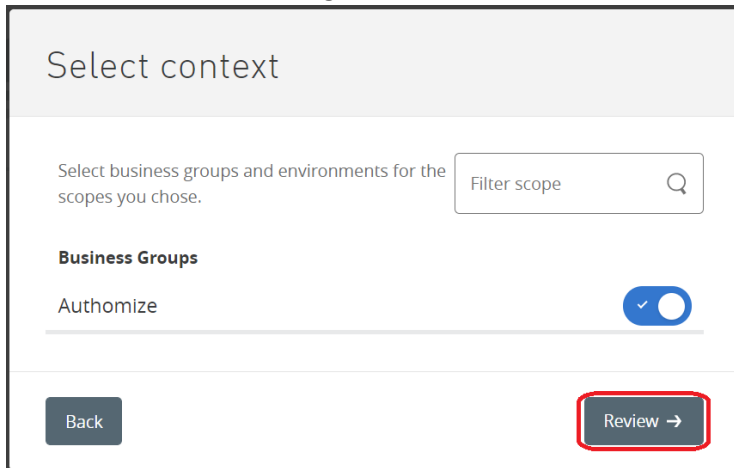

9. Confirm that you picked the right scope. If yes, click **Add Scopes**.

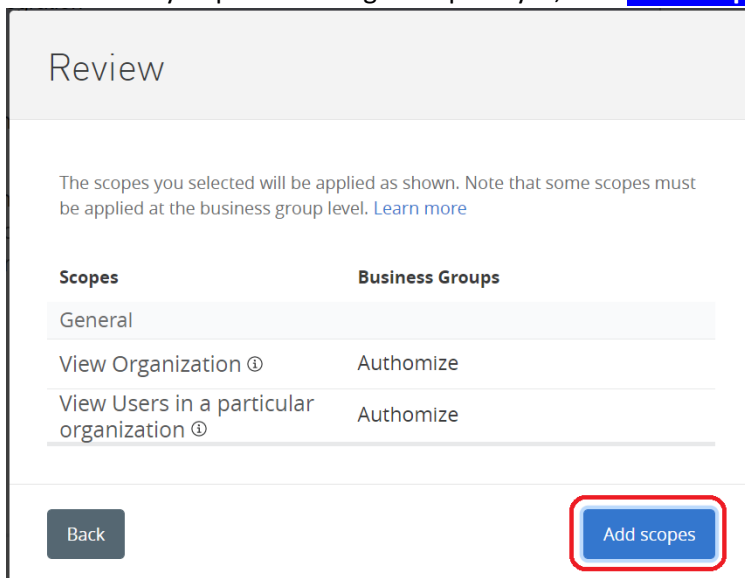

10. Save your app.

Create App

Name

Authomize-Integration

Type

App acts on behalf of a user
Authorized by a user to act on their behalf.

App acts on its own behalf (client credentials)
Acts on its own behalf without impersonating a user.
The app can only be used in this organization.

Scopes	Business Groups	
General		
View Organization ⓘ	Authomize	Manage
View Users in a particular organization ⓘ	Authomize	Manage

Cancel Add Scopes Save

11. Copy the **Client ID** and Client **Secret** to the Integrate Authomize dialog in Authomize.

Connected Apps

Owned Apps Authorizations Scopes Documentation

Create app This tab contains apps that were created in this organization. [Learn more](#) about connected apps.

Name	Users ⓘ	
Authomize-Integration	n/a	Copy Id Copy Secret ...
██████████████████	n/a	Copy Id Copy Secret ...

Integration MuleSoft with Authomize

1. Log into **Authomize**.
2. Go to the **Settings/Data Sources** page.
3. Click **Add New App** and pick **MuleSoft**.

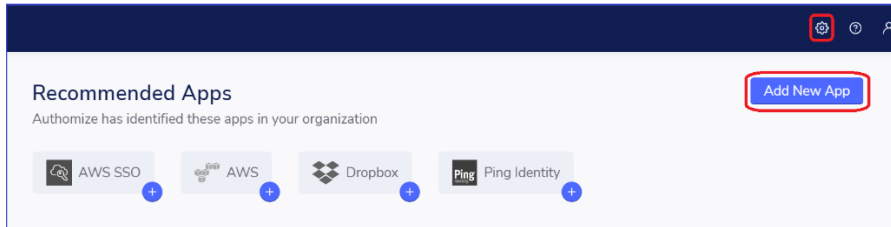

4. In the **Integrate MuleSoft** dialog:

Step 1. Copy/Paste **Organization ID**, **Client ID** and **Client Secret** from **MuleSoft**.

Step 2. Enter an Integration Name.

Step 3. Enter the integration owner's email.

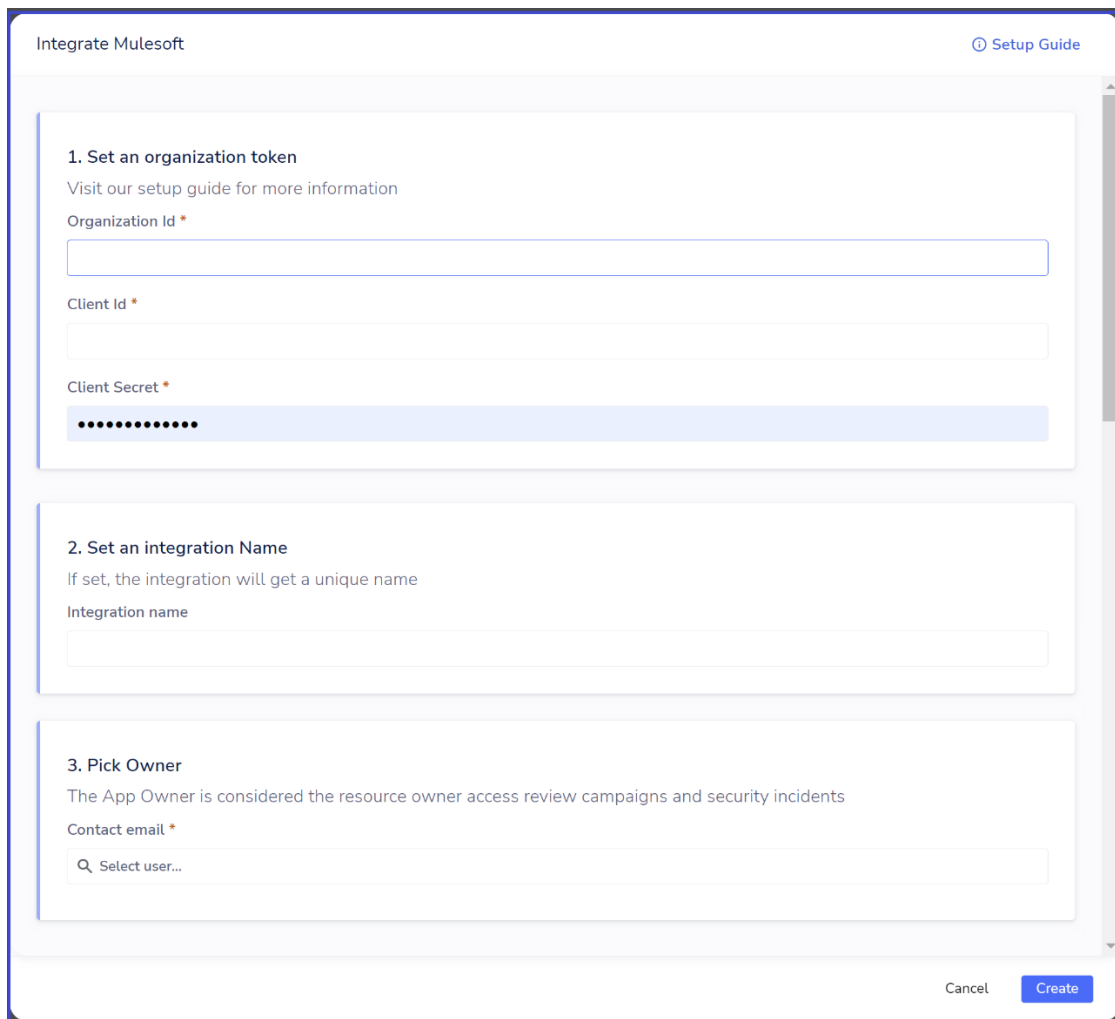

5. Click **Create**.

You will see a MuleSoft entry in the Connected Apps list after it is created:

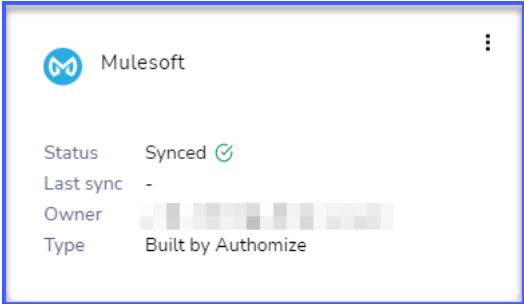

What data is collected

Application

Users

Groups